



# VISTABORD



**FLEXABORD**



**Multiflex**

**External / Internal  
Ceilings**

**Internal Wet  
Area Linings**

**Internal Drywall  
Systems**



041 - 036  
Made From Reused  
Waste Materials



Institut Bauen  
und Umwelt e.V.





This sign endorses that  
the product is asbestos-free



CERTIFIED TO MS ISO 9001 : 2008  
Registration No. : AR 0387

**UCO VISTABORD** is a sanded smooth surfaced asbestos-free fibre reinforced cement board with recessed edges. The unsanded surface equivalent, **UCO FLEXABORD** can also be manufactured. **UCO Vistabord** is the ultimate flush-jointable board, developed to create a homogeneous seamless joint that can be tiled-on. This board is also available with square edges, **UCO MULTIFLEX**.

|                            |                                      |                                   |                                      |
|----------------------------|---|---|---|
| <b>Product Description</b> | <b>UCO Vistabord</b> is fibre cement board.<br><br>It is a <b>sanded</b> smooth surfaced, <b>recessed edge</b> board. | <b>UCO Multiflex</b> is fibre cement board.<br><br>It is a <b>sanded</b> smooth surfaced, <b>square edge</b> board. | <b>UCO Flexabord</b> is fibre cement board.<br><br>It is a <b>unsanded</b> smooth surfaced, <b>recessed edge</b> board. |
|                            | Sanded      Recessed edge<br><b>UCO Vistabord</b><br>Light sanded   | Sanded      Square edge<br><b>UCO Multiflex</b><br>Light sanded   | Unsanded      Recessed edge<br><b>UCO Flexabord</b><br>Unsanded   |

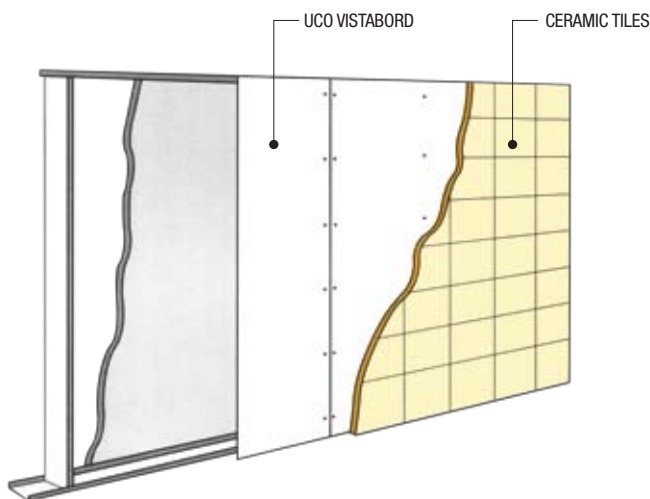

**UCO Vistabord Internal Wet Area Linings**

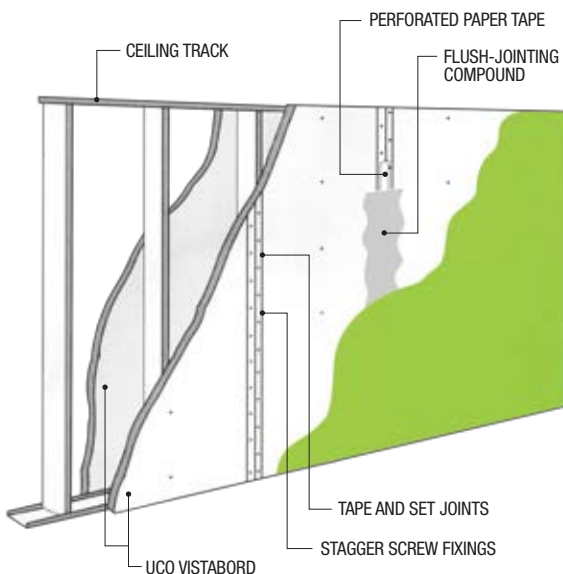

**UCO Vistabord Internal Drywall System**

## UCO Vistabord / Multiflex Applications

### 1) INTERNAL DRYWALL SYSTEMS :-

- (i) Internal Wet Area Linings
  - Standard commercial tiled walls
  - Heavy duty tiled walls
- (ii) Internal Dry Walling
  - a) Non Fire-Rated Partition System
    - office buildings
    - schools
    - shops
    - residential houses
  - b) Fire-Rated Partition System
    - Industrial buildings
    - Hospitals
    - Corridors
    - Hotels
  - c) Sound Insulation System
- (iii) Ducting & Service Duct

### 2) EXTERNAL SOFFITS

### 3) INTERNAL CEILINGS

### 4) FIRE DOORS

## ADVANTAGES

### LIGHTWEIGHT

Reduces weight of walls by approximately 70% compared with brick walls.

### IMPACT / ABRASION-RESISTANT

Scuff-resistant, offering superior impact and abrasion resistance.

### FINISH VERSATILE

Can accept a variety of finishes, including paint, texture coating, tiles and wallpaper.

### RAPID INSTALLATION

Easily and rapidly constructed, cutting down construction time and cost compared to the wet trade.

## ADVANTAGES

### LIGHTWEIGHT

Reduces weight of walls by approximately 70% compared with brick walls.

### IMPACT / ABRASION-RESISTANT

Scuff-resistant, offering superior impact and abrasion resistance.

### FINISH VERSATILE

Can accept a variety of finishes, including paint, texture coating, tiles and wallpaper.

### RAPID INSTALLATION

Easily and rapidly constructed, cutting down construction time and cost compared to the wet trade.

### DRY CONSTRUCTION

Reduces messiness and therefore clean-up at site. Also

### Sheet Layout Around Openings

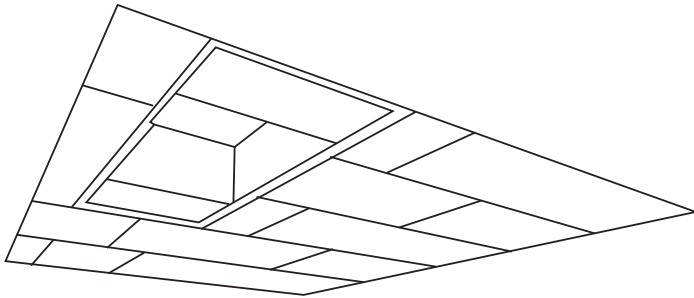
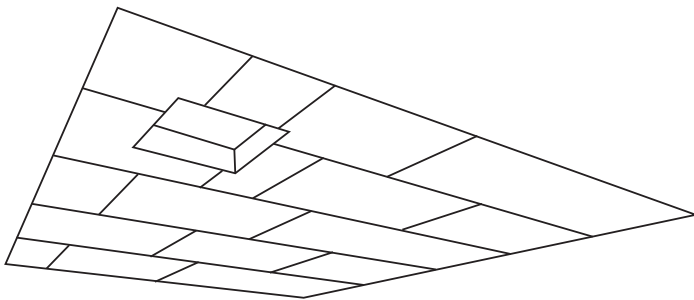

## PRODUCT CHARACTERISTICS

### BASIC COMPOSITION

UCO Vistabord is manufactured from cement, refined sand and specially treated cellulose fibre.

### FIRE RESISTANCE

UCO Vistabord conforms to the following:

- a. Uniform Building By-Laws 1984 Class 'O'
- b. BS 476 Part 6 (fire propagation)  
Fire propagation Index, I = 0.1 to 0.2  
Sub-index i. 1 = 0.2  
              i. 2 = 0.0  
              i. 3 = 0.3
- c. BS 476 Part 7 (surface spread of flame) Class (1)  
– No flame spread

### DENSITY (oven dry)

6.0mm & 9.0mm – 1.32g/cc<sup>3</sup>

### MOISTURE CONTENT AT EQUILIBRIUM

EMC 8%

### MOISTURE MOVEMENT

EMC to saturated 0.06%

EMC to oven dry 0.12%

### WATER ABSORPTION

BY weight 30%

### THERMAL CONDUCTIVITY

Estimated at 25° C 0.12W/mk

### THERMAL EXPANSION COEFFICIENT

Estimated 7.5 x 10<sup>-6</sup>

### SOUND TRANSMISSION LOSS

Estimated 6.0mm – 25dB

9.0mm – 28dB

### FLEXURAL STRENGTH (MOR)

EMC average 17 MPa

Saturated average 12 MPa

## DIMENSIONS

**Thickness** 6.0mm and 9.0mm  
7.5\*mm, and 12.0\*mm

**Length** 2440mm  
2745\*mm and 3050\*mm

**Width** 1220mm

*\*subject to stock availability and economic production run*

## ACCESSORIES

### Screws

For 6.0mm thick board fixed onto light gauge steel framing (less than 1.0mm thick), use Streaker no. 8 self-embedding head screws:

- 25mm long for single-layer applications
- 45mm long for double-layer applications

above 6.0mm thick board fixed onto steel framing (thickness: minimum 1.0mm & maximum 1.6mm), use wing-tip self-embedding teks screws:

- 30mm long for single-layer applications
- 40mm long for double-layer applications

### Expansion Joints

Rondo 33 Expansion Joint Kit is recommended for flush jointing to cater for board movement.

### Steel Framing

Framing sections shall be galvanised or zinc-coated with a minimum base steel (BMT) of 0.55mm, i.e. typically 0.6mm coating thickness.

### Flush-Jointing Compound

For wet area applications, a cementitious jointing compound should be used. Our technical personnel should be consulted for assistance to ensure the right material is used.

### Corner Beading

To flush external corners, use perforated metal corner beads over the corner sheet edge before fixing with screws or clouts. In wet area applications, use perforated plastic corner beads.

### Joint Reinforcing Tape

Perforated paper reinforcing tapes are recommended for flush setting of joints to achieve good results. Woven-linen and self-adhesive tapes must not be used.

## LIMITATIONS OF FLUSH JOINTED WALLS

Flush jointing is not recommended for sheets fixed directly to purlin or girts as these members are usually subject to the thermal and structural movement beyond the capacity of a flush joint.

## REFERENCES

UCO Vistabord for drywall partition



UCO Vistabord application for Internal Ceilings.



UCO Vistabord for suspended ceiling



UCO Vistabord used as external soffits and wall cladding

## BUILDING PRODUCTS SPECIFICATION

### INTERNAL CEILING

**UCO Vistabord** flush-jointed ceiling using 6mm thick board fixed onto minimum 0.5mm thick metal suspended system ie: Lexington & Rondo. All joints are to be flush-jointed with perforated paper tape and water resistant compound.

### WALL / PARTITION

#### Double Skin:

**UCO Vistabord** flush-jointable drywall system using 9mm thick board for **external** and 6mm thick board for **internal**, fixed onto G.I. channels vertically @ 610mm c/c (main steel structural framing & finishes by others). All joints to be flush-jointed with perforated paper tape.

External wall to be flush-jointed with water resistant compound and gypsum jointing compound for internal wall.

#### Single skin:

To supply and install **UCO Vistabord** flush-jointed **internal** drywall system using 2440mm x 1220mm x 6mm thick high moisture resistant fibre cement board, fixed onto G.I. channels vertically @ 610mm c/c. All joints to be flush-jointed with perforated paper tape and compound, excluding main steel structural framing & finishes.

## WARRANTY

The recommendations in this brochure are formulated along the lines of good buildings practice. However, this brochure is not intended to be an exhaustive statement of all relevant data.

As the success of building projects depends on many factors outside UAC's control (e.g. quality of workmanship, particular design detail requirements etc.). UAC accepts no responsibility or liability for or in connection with the quality of the projects or their suitability when completed.

For a warrant period of one year from date of delivery of UAC's products ("UAC Products") to the purchaser ("Warranty Period"), UAC warrants that the UAC Products are free from defects which are solely due to materials or manufacturing faults. The foregoing warranty shall not apply to the extent that:

- the defect, loss or damage is caused by any act, default or misuse of the UAC Products (or part thereof) by the purchaser or any third party or by failure to follow any instructions or specifications of UAC or by modification of the UAC Products or installation, application and/or combination of the UAC Products with any other product not approved by UAC; or
- UAC is not notified in writing within Warranty Period of any relevant defect in the UAC Products or part thereof.

Subject to such provisos, UAC will at its sole option and subject to the investigations, verifications and inspections of such defect by a UAC representative, either (a) replace such defective UAC Product or part thereof; or (b) re-fund the price paid for the defective UAC Product or part thereof. The liability of UAC shall include only Products with antecedent defects. The liability cannot be extended to include Products without defects which might have been delivered at the same time as the defective Products. The foregoing shall be the sole and exclusive remedy in the event of any breach of the said warranty.

To the greatest extent permitted by any applicable law, the warranties referred to the above shall be sole and exclusive and in lieu of all implied or statutory warranties (including without limitation, the implied warranties imposed by the Malaysian Sale of Goods Act 1957 and all other warranties implied by law as to merchantability, satisfactory quality or fitness for a particular purpose, or otherwise arising from course of dealing or usage of trade) or any other express or implied warranties or representations.

To the greatest extent permitted by any applicable law, in no event shall UAC be liable to the purchaser or any other person or entity for any loss or damage including without limitation special, indirect, incidental, punitive, exemplary, or consequential damages, loss of profits, loss of business or loss of use; whether based upon contract, tort, negligence or otherwise arising out of the manufacture, sale or delivery of the UAC Products, even if UAC has been advised of the possibility of such damage or loss.

**BUILD BETTER WITH**



**the NAME you can TRUST**

**UAC BERHAD** (5149 H)

(Incorporated in Malaysia / A member of Boustead Group)

Level 10, Menara UAC, No. 12, Jalan PJU 7/5, Mutiara Damansara, 47800 Petaling Jaya, Selangor Darul Ehsan, Malaysia.

+603-7721 9393

+603-7721 9300

sales@uac.com.my

www.uac.com.my